

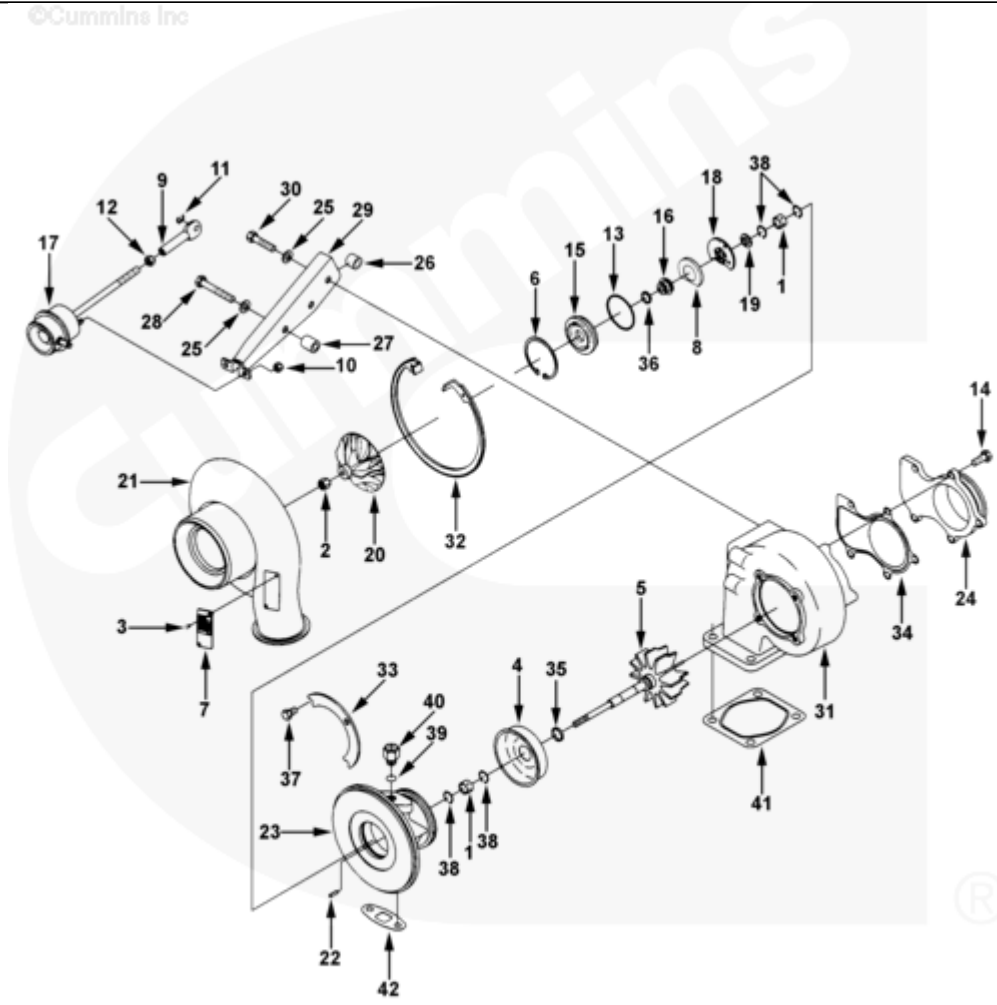

## Parts Catalog - Option Detail

Electronic Parts Catalog - Option Detail				
Option	Group	Graphic	Film Card	Date
PP97012-01	10.06	tb953gi	Z	23-OCT-95
<b>Engines</b>	6C8.3, C GAS PLUS CM556, G8.3, G8.3 CM558, GTA8.3 CM558, ISC CM2150, ISC CM554, ISC CM850, ISC8.3 CM2250, ISC8.3 G CM2180 C101, ISL CM2150, ISL CM554, ISL CM850, ISL G CM2180, ISL8.9 CM2150 L110, ISL8.9 CM2880 L112, ISL9 CM2150 SN, ISL9 CM2250, ISL9 CM2350 L101, ISL9 CM2350 L111, ISLE4 CM850, L GAS PLUS CM556, L8.9, L8.9 L121, L8.9G CMOH2.0 L125B, L9 CM2350 L116B, L9 CM2350 L119B, L9 CM2350 L120C, L9 CM2350 L123B, L9.3 L105, L9.5 L117, L9N CM2380 L124B, QSC8.3 CM2250, QSC8.3 CM2880 C102, QSC8.3 CM554, QSC8.3 CM850(CM2850), QSL9 CM2250, QSL9 CM2250 L115, QSL9 CM2350 L102, QSL9 CM2350 L107, QSL9 CM2350 L118, QSL9 CM2350 L122, QSL9 CM554, QSL9 CM850(CM2850), QSL9 G CM558, QSL9 M CM2250 L106, QSL9.3 CM2880 L113			



tb953gi

[SMALL](#) | [MEDIUM](#) | [LARGE](#)

Cart	Ref No	Part Number	Part Description	Required	Remarks
------	--------	-------------	------------------	----------	---------

View My Cart

		<a href="#">PP97012-01</a>	Turbocharger		<a href="#">MR - TURBOCHARGER...(More)</a>
					Engine Family: C Series
					Turbo Location: HMRO
					Base ID17 Turbo: 3533005
					Turbo Type: Wastegate
					Wastegate Pressure Setting
					(BAR): 0
					Turbo Model: HX40W
					Compressor Angle (shipping
					deg): 225
					Turbine Angle: 15
					Structure Code: 02 EBM
					Engine Cylinders: 6
					Active Oil Cooled Turbo
		<a href="#">3533006</a>	Turbocharger	1	
<input type="checkbox"/>		<a href="#">3533005</a>	Turbocharger	1	Recon Equivalent 3802614 RX
<input type="checkbox"/>	1	<a href="#">3503100</a>	Turbocharger Bearing	2	
<input type="checkbox"/>	2	<a href="#">3503562</a>	Lock Nut	1	M7 x 1.00
<input type="checkbox"/>	3	<a href="#">3519163</a>	Drive Screw	2	
<input type="checkbox"/>	4	<a href="#">3519302</a>	Turbocharger Heat Shield	1	
<input type="checkbox"/>	5	<a href="#">3522879</a>	Shaft And Wheel	1	
<input type="checkbox"/>	6	<a href="#">3527566</a>	Retaining Ring	1	
	7	<a href="#">3527619</a>	Dataplate	1	
<input type="checkbox"/>	8	<a href="#">3528104</a>	Oil Baffle	1	
	9	<a href="#">3528177</a>	Adjusting Link End	1	
<input type="checkbox"/>	10	<a href="#">3528204</a>	Regular Hexagon Nut	2	1/4 - 28 UNF
<input type="checkbox"/>	11	<a href="#">3528221</a>	Retaining Ring	1	Holset Part Sold Only in Kits
	12	<a href="#">3528414</a>	Regular Hexagon Jam Nut	1	Holset Part Sold Only In Kits

<input type="checkbox"/>	13	3528933	O-Ring Seal	1	
<input type="checkbox"/>	14	3530556	Hexagon Head Set Screw	5	M8 X 1.25 X 20.
<input type="checkbox"/>	15	3530923	Oil Seal Plate	1	
<input type="checkbox"/>	16	3530924	Oil Slinger	1	
	17	3531892	Turbocharger Actuator	1	
<input type="checkbox"/>	18	3532215	Turbocharger Thrust Bearing	1	
<input type="checkbox"/>	19	3532217	Thrust Collar	1	
<input type="checkbox"/>	20	3536444	Turbocharger Compressor Impeller	1	
<input type="checkbox"/>	21	3532423	Compressor Housing	1	
<input type="checkbox"/>		3532632	Turbocharger Bearing Housing	1	
	22	3522597	Roll Pin	1	
	23	3532631	Turbocharger Bearing Housing	1	
<input type="checkbox"/>	24	3533030	Adapter Connection	1	
<input type="checkbox"/>	25	3504967	Plain Washer	3	Holset Part Sold Only In Kits
<input type="checkbox"/>	26	3532195	Mounting Spacer	3	
<input type="checkbox"/>	27	3532196	Mounting Spacer	1	
<input type="checkbox"/>	28	3532298	Hexagon Head Set Screw	1	M8 x 1.25 x 55
<input type="checkbox"/>	29	3532671	Actuator Bracket	1	
<input type="checkbox"/>	30	3532940	Hexagon Head Set Screw	2	M8 x 1.25 x 35
	31	3534353	Turbine Housing	1	
<input type="checkbox"/>	32	3533163	Retaining Ring	1	
<input type="checkbox"/>	33	3534309	Clamping Plate	2	Customers Order P/N 2839879
<input type="checkbox"/>	34	3535243	Adapter Gasket	1	
<input type="checkbox"/>	35	3756754	Split Ring Seal	1	
<input type="checkbox"/>	36	3758848	Split Ring Seal	1	
<input type="checkbox"/>	37	3759917	Hexagon Head Set Screw	6	M8 X 1.25 X 12.
<input type="checkbox"/>	38	3762259	Retaining Ring	4	
<input type="checkbox"/>	39	3037236	O-Ring Seal	1	Ref. SPT 97T10
<input type="checkbox"/>	40	3920801	Female Connector	1	

<input type="checkbox"/>	41	<a href="#">3911941</a>	Turbocharger Gasket	1	
<input type="checkbox"/>	42	<a href="#">3519807</a>	Turbocharger Gasket	1	Holset P/N 3914388

© 2019 Cummins Inc., Box 3005, Columbus, IN 47202-3005 U.S.A.  
Terms of Use and Disclaimers | Recommended System Requirements  
Need Assistance? Please click on the Contact Us button in the top right corner of any page.